



FAULKNER HOUSE, LONDON, W6



ASKING PRICE
£695,000



FAULKNER HOUSE, TIERNEY LANE, W6

- One bed apartment
- Riverside development
- Reception with Dining area
- Fitted Kitchen with breakfast bar
- Modern bathroom
- Private balcony
- 24h Concierge and Fitness Suite
- 5 minutes' walk to Hammersmith tube station

Luxury apartment located in the sought after riverside Fulham Reach development in the heart of Hammersmith.

Walking distance to the multiple shops, restaurants and Hammersmith Underground Station (Piccadilly and District lines) which has excellent travel links around London.

The apartment is presented to a high standard and comprising a reception room with dining area, floor to ceiling windows that lead out to a private balcony, a fully fitted kitchen with integrated appliances and breakfast bar, double bedroom with fitted wardrobe, bathroom.

The development offers 24-hour concierge, access to the private members club with snooker room, cinema room, and fitness



FAULKNER HOUSE, TIERNEY LANE, W6

Approximate gross
internal area:
54.6 SQM /
588 SQ FT

Tierney Lane, W6 9AE

Approx Gross Internal Area = 54.63 sq m / 588 sq ft
Balcony = 6.17 sq m / 66 sq ft
Total = 60.8 sq m / 654 sq ft

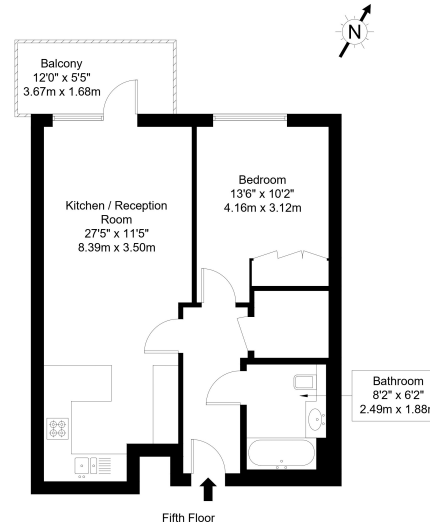

Tenure: Leasehold, 0 years

Estimated ground rent: £520.8 p.a.

Estimated service charge: £4642.36 p.a.

info@fraser.uk.com
www.fraser.uk.com

Kew Bridge and Brentford Sales Office
571 Chiswick High Road
London, W4 3AY
Tel: 020 8747 0661

FRASER
& Co

Score	Energy rating	Current	Potential
92+	A		
81-91	B	87 B	87 B
69-80	C		
55-68	D		
39-54	E		
21-38	F		
1-20	G		

info@fraser.uk.com
www.fraser.uk.com

Kew Bridge and Brentford Sales Office
 571 Chiswick High Road
 London, W4 3AY
 Tel: 020 8747 0661

